

## slimline STRIPES [3]

### PRODUCT IMAGE



### TECHNICAL DATA

<b>product description:</b>	Decorative acoustic panel for walls and ceilings for mounting on substructure.
<b>dimension:</b>	2.784 x 192 mm
<b>slotting:</b>	STRIPES [3]
<b>core-board:</b>	16 mm MDF B2 E1 drilled
<b>surface:</b>	veneer   CPL   melamine
<b>fire classification:</b>	C-s2, d0 acc. DIN EN 13501-1 (in composite) limited contribution to fire (others on request)
<b>edges:</b>	longitudinal : tongue and groove system transverse : industrial saw cut
<b>mounting:</b>	vertical   horizontal wall   ceiling
<b>accessories:</b>	mounting-clip (optional)

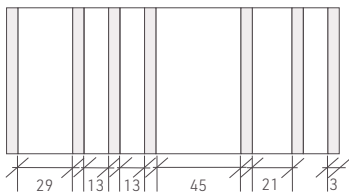

**slotting:**  
3 mm slot + 13-35 mm slat (irregular)

#### PROVISIONAL NOTE:

This data sheet has been prepared to the best of our knowledge and belief. No liability can be assumed for printing and standard errors as well as errors. Due to (product) further development, there may be changes to the available data. The content of this data sheet should not be used as a legally binding basis.

### SOUND ABSORPTION VALUES

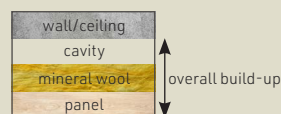

overall build-up	46 mm	76 mm
cavity (open)	-	-
mineral wool	30 mm	60 mm
panel thickness	16 mm	16 mm
<b>frequency [Hz]</b>	<b><math>\alpha_s</math></b>	<b><math>\alpha_s</math></b>
100	0,08	0,28
125	0,21	0,44
160	0,35	0,71
200	0,56	0,83
250	0,66	0,93
315	0,75	0,88
400	0,80	0,85
500	0,83	0,87
630	0,84	0,84
800	0,86	0,77
1000	0,85	0,79
1250	0,79	0,78
1600	0,78	0,74
2000	0,76	0,74
2500	0,76	0,77
3150	0,71	0,75
4000	0,67	0,70
5000	0,64	0,65
<b><math>\alpha_w</math></b>	<b>0,80</b>	<b>0,80</b>
<b>absorber class</b>	<b>B</b>	<b>A</b>

